

Modification Date	Modification Person	Modification Order No.	Rev.	Zone	Contents for Modification

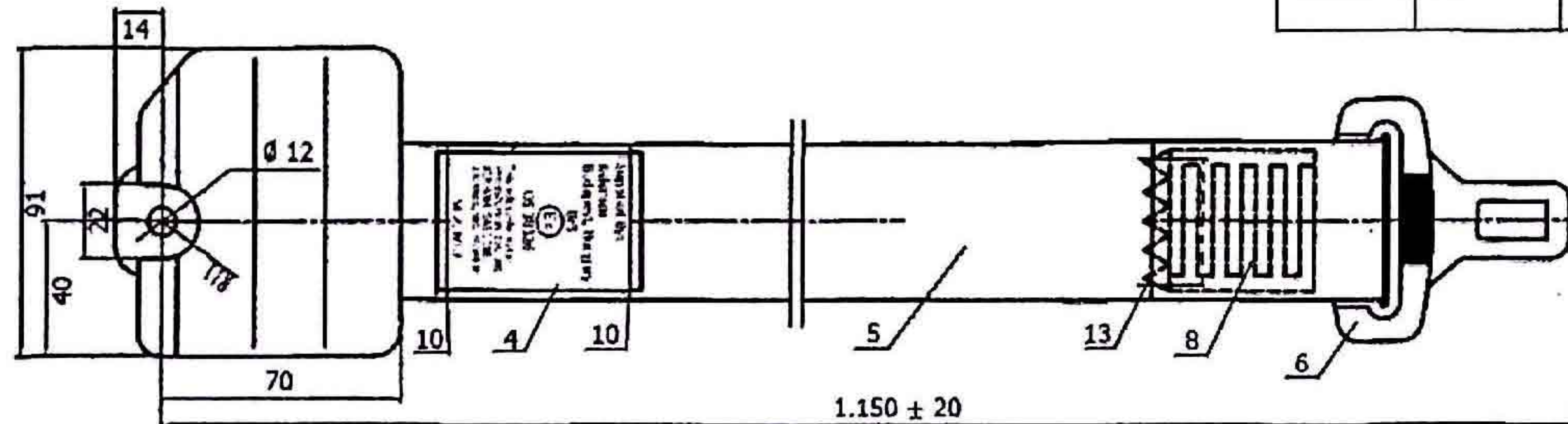

General Notes:

1. Unless otherwise stated, all dimensions are in mm.
2. Do not scale the drawing.

Special Notes:

1. Performance of the seat belt assy shall confirm to the requirements of ECE R 16-06, EEC 77/541 ff (2005/40), FMVSS 209, ADR 4/04.
2. Retraction & withdrawal of the retractor should be flexible and without unusual noises.
3. Buckle shall be structured without half latching.
4. The colour of press button shall be red and marked with "PRESS". All other visible plastic parts shall be black only.
5. All metal parts should be free from hexavalent chromium.
6. Webbing cut length 1.200 mm.
7. Webbing colour shall be black.
8. Retractor type 3.
9. Position 7, 11 and 12 separate packed in a Polybag.

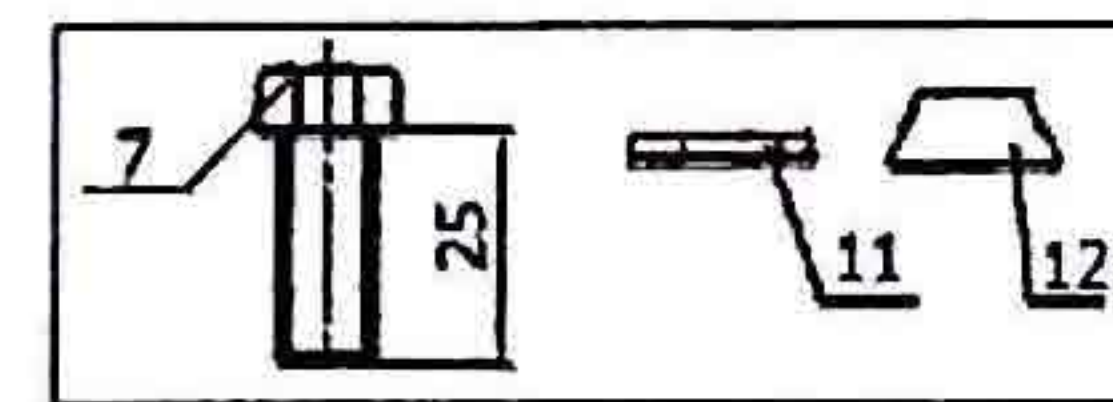
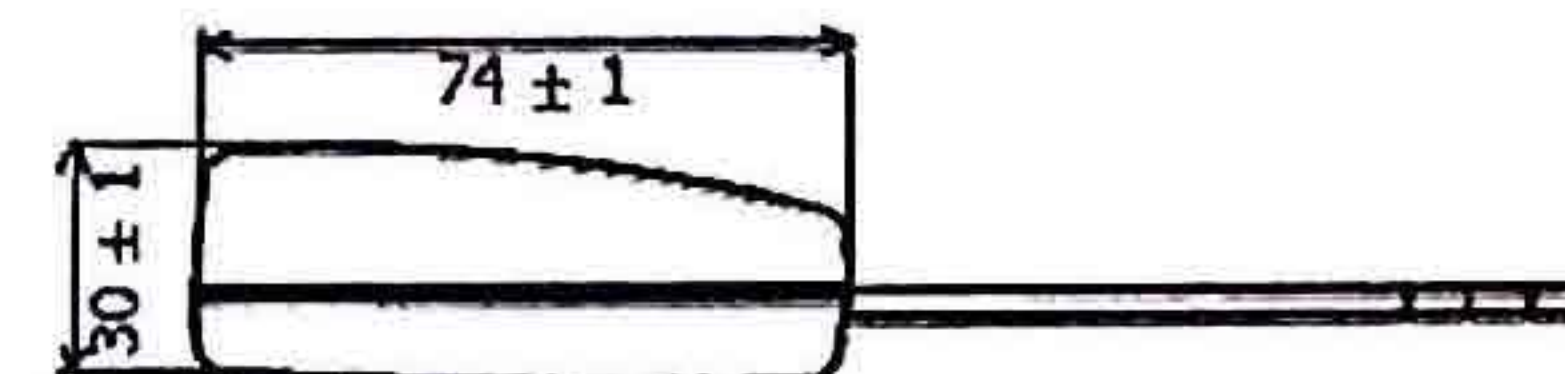
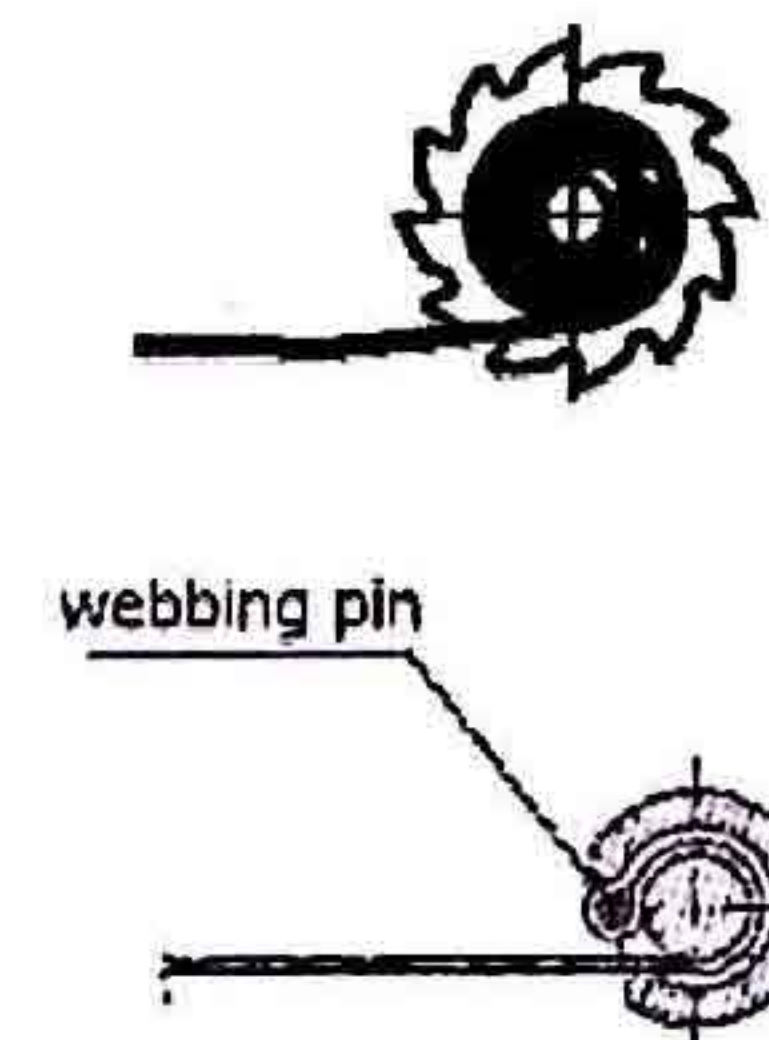
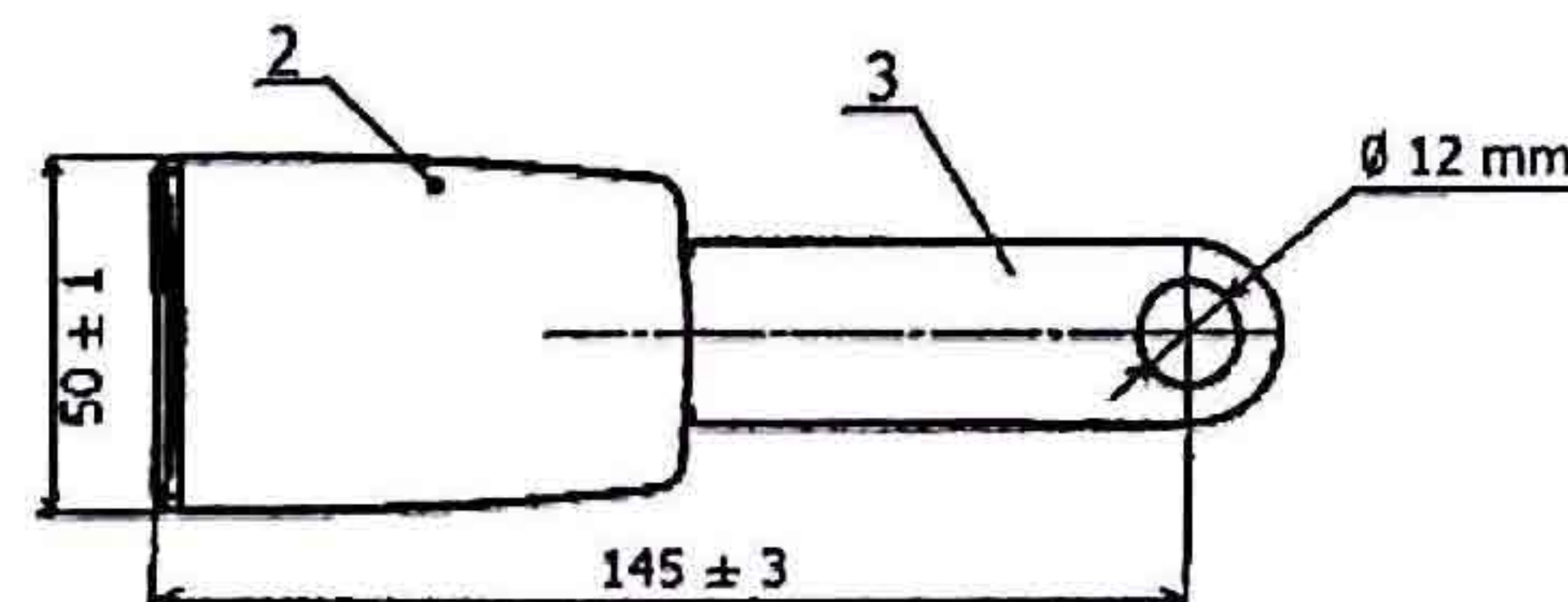
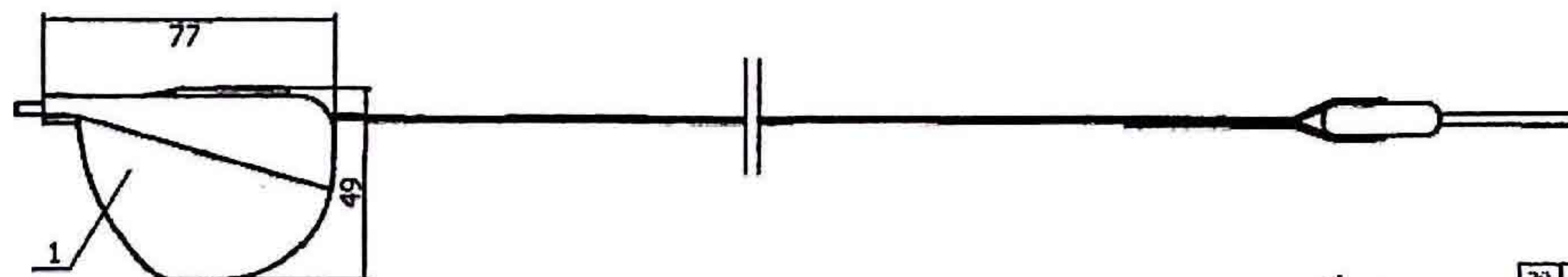

20						
19						
18						
17						
16						
15						
14						
13	Nahtbild Nr. 9	Stitching Pattern No. 9	1	09.120-618-00		710-280
12	Schraubenkopfkappe SW 17	Bolt Head Cover SW 17	2	09.120-433-00		
11	U-Scheibe 2 mm	Washer 2 mm	2	09.120-301-00		
10	Nahtbild Nr. 1	Stitching Pattern No. 1	1	09.120-610-00		straight
9	Nahtbild Nr. 11	Stitching Pattern No. 11	1	09.120-620-00		72 Stitches
8	Nahtbild Nr. 14	Stitching Pattern No. 14	1	09.120-623-00		144 Stitches
7	Schraube 7/16" x 25 mm	Bolt 7/16" x 25 mm	2	09.120-207-00		7/16"
6	K-12 gerade Zunge	K-12 straight Tongue	1	09.140-050-00		K-12
5	Gurtband 1,2 mm, 1.200 mm	Webbing 1,2 mm, 1.200 mm	1	09.190-263-00		1.200 mm
4	ECE-Etikett Br3	ECE-Label Br3	1	09.190-909-00		
3	Schlossbeschlag	Buckle Bracket	1	09.140-135-00		all kinds 330 mm
2	K-12 Schlosskopf VS	K-12 Buckle Head Front	1	09.140-201-00		K-12
1	ALR Retraktor langes Geh.	ALR Retractor long base	1	09.170-201-00		12 Teethes
No.	Part Description	Part Description	Qty	Drawing Number	Drwg. No.	Remarks

Nahtbild Nr. 14/144 Stiche = 09.120-623-00
 Nähgarn 8/3 schwarz = 09.120-600-00
 Nahtbild Nr. 11/72 Stiche = 09.120-620-00
 Nähgarn 8/3 schwarz = 09.120-600-00
 Nahtbild Nr. 1/Geradstich = 09.120-610-00
 Nähgarn 20/3 Schwarz = 09.120-601-00
 Stitching Pattern No. 14/144 Stitches = 09.120-623-00
 Sewing Thread / Yarn 8/3 black = 09.120-600-00
 Stitching Pattern 11/72 Stitches = 09.120-620-00
 Sewing Thread / Yarn 8/3 black = 09.120-600-00
 Seam No. 1/Straight = 09.120-610-00
 Sewing Thread/Yarn 20/3 Black = 09.120-601-00

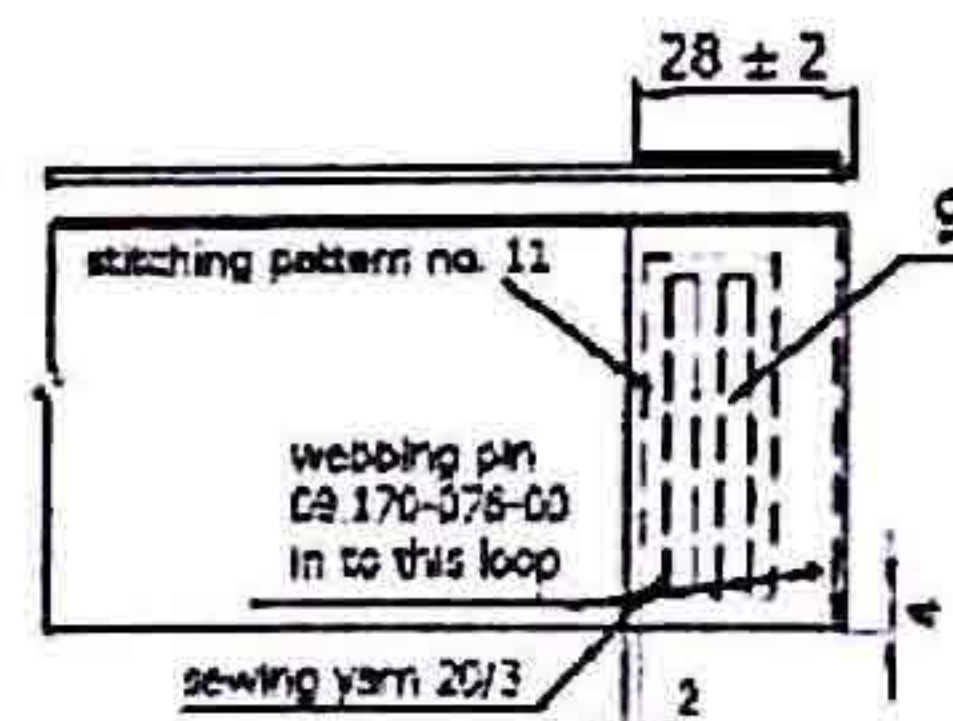
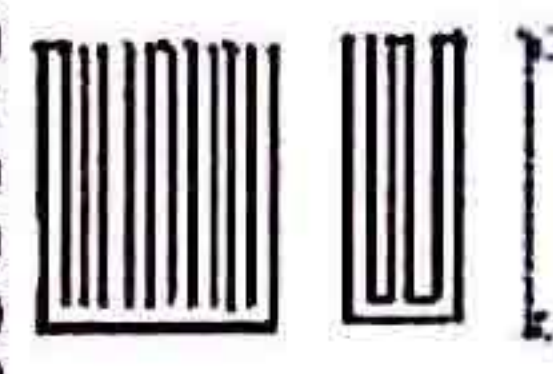

Supplied By:
 Kelemen
 Budapest, Hungary
 CE
 Br3
 E4
 05 38326
 This belt conforms to:
 FMVSS/CHVSS 209, 302
 ADR 4/04, SAE J 386,
 ISO 6683, EEC 77/541 ff
 M 2, M 3

Surface Finish		2-Point Automatic Belt with 145 mm Bracket Buckle		Drawing Number	006 / 500
Heat Treatment				Part Number	
Material		Customer: BHI UK			
Projection Angle		Size	A 4	Customer Part No.	
Drawn		Std.			
Checked		Countersign			
Technics		Countersign			
Drawn		Approved	23.01.2015 ZK	Weight	